

# Pecyn Dogfennau



Mark James LLM, DPA, DCA  
Prif Weithredwr,  
Chief Executive,  
Neuadd y Sir, Caerfyrddin. SA31 1JP  
County Hall, Carmarthen. SA31 1JP

**DYDD MAWRTH, 19EG EBRILL, 2016**

**AT: HOLL AELODAU'R IS-BWYLLGOR TRWYDDEDU "A"**

**YR WYF DRWY HYN YN EICH GALW I FYNYCHU CYFARFOD O'R IS-BWYLLGOR TRWYDDEDU "A" A GYNHELIR YN Y SIAMBR, NEUADD Y SIR, CAERFYRDDIN AM 10.30 A.M. AR DDYDD MAWRTH, 26AIN EBRILL, 2016 ER MWYN CYFLAWNI'R MATERION A AMLINELLIR AR YR AGENDA SYDD YNGHLWM**

*Mark James*

**PRIF WEITHREDWR**



**AILGYLCHWCH OS GWELWCH YN DDA**

<b>Swyddog Democrataidd:</b>	<b>Michelle Evans Thomas</b>
<b>Ffôn (llinell uniongyrchol):</b>	<b>(01267) 224470</b>
<b>Ffacs:</b>	<b>(01267) 224911</b>
<b>E-bost:</b>	<b>MEEvansThomas@sirgar.gov.uk</b>
<b>Cyf:</b>	<b>AD016-001</b>

**IS-BWYLLGOR TRWYDDEDU "A"**  
**3 AELOD**

**BYDD TRI AELOD O'R IS-BWYLLGOR YN GWNEUD PENDERFYNIAD YNGHYLCH POB CAIS. CAIFF AELODAU'R IS-BWYLLGOR EU DEWIS O BLITH Y PUM AELOD CANLYNOL YN EU TRO AC YN ÔL YR ANGEN.**

- |   |                             |
|---|-----------------------------|
| <b>1. Y Cynghorydd P.M. Edwards</b>           | <b>(y Grŵp Llafur)</b>      |
| <b>2. Y Cynghorydd H.I. Jones [Cadeirydd]</b> | <b>(y Grŵp Annibynnol)</b>  |
| <b>3. Y Cynghorydd J. Thomas</b>              | <b>(y Grŵp Plaid Cymru)</b> |
| <b>4. Y Cynghorydd M.K. Thomas</b>            | <b>(y Grŵp Llafur)</b>      |
| <b>5. Y Cynghorydd D.E. Williams</b>          | <b>(y Grŵp Plaid Cymru)</b> |

**NODER :**

**OS NA FYDD YN BOSIBL I DRI O'R AELODAU UCHOD WNEUD PENDERFYNIAD YNGHYLCH POB CAIS, CAIFF AELODAU ERAILL O BLITH Y PWYLLGOR TRWYDDEDU EU DEWIS YN EU LLE.**

# AGENDA

1. DATGAN BUDDIANNAU PERSONOL
2. CAIS I AMRYWIO TRWYDDED SAFLE - GWESTY'R PORTHMYN, 5 - 52  
106 HEOL AWST, CAERFYRDDIN

Mae'r dudalen hon yn wag yn fwriadol

## YR IS-BWYLLGOR TRWYDDEDU "A"

26/04/2016

## PWNC A PHWRPAS

## Cais i Amrywio Trwydded Safle

Gwesty'r Porthmyn, 106 Heol Awst, Caerfyrddin SA31 3AP

## Y PENDERFYNIADAU ALLWEDDOL SYDD EU HANGEN:

Bod yr Is-bwyllgor yn ystyried y cais a'r holl sylwadau a thystiolaeth a gyflwynwyd ac yn cymryd sylw o Bolisi Trwyddedu yr Awdurdod a'r Cyfarwyddyd Cenedlaethol.

## Y RHESYMAU:

1) Mae'n ofynnol i'r Pwyllgor hyrwyddo'r amcanion trwyddedu sef: -

- Atal Troseddau ac Anhrefn.
- Diogelu'r Cyhoedd.
- Atal Niwsans Cyhoeddus.
- Amddiffyn Plant rhag Niwed.

Ymgynghorwyd â'r Pwyllgor Craffu perthnasol	Amherthnasol
Angen i'r Bwrdd Gweithredol wneud penderfyniad	Amherthnasol
Angen i'r Cyngor wneud penderfyniad	Amherthnasol

YR AELOD O'R BWRDD GWEITHREDOL SY'N GYFRIFOL AM Y PORTFFOLIO:- Y Cyngorydd T.J. Jones (Diogelu'r Cyhoedd a'r Amgylchedd)

Y Gyfarwyddiaeth: Cymunedau Enw Pennaeth y Gwasanaeth Mr Robin Staines  Awdur yr adroddiad	Swydd:  Pennaeth Tai a Diogelu'r Cyhoedd  Swyddog Trwyddedu Andrew Rees	Rhif Ffôn: 01267 228960 Cyfeiriad E-bost: <a href="mailto:rstaines@sirgar.gov.uk">rstaines@sirgar.gov.uk</a>  Rhif ffon: 01267 228787 rarees@sirgar.gov.uk
--	---	---



**EXECUTIVE SUMMARY**  
**Licensing Sub-Committee "A"**  
**26/04/2016**

**Application to Vary a Premises Licence**  
**Drovers Arms Hotel, 106 Lammas Street,**  
**Carmarthen, SA31 3AP**

To consider an application from Felinfoel Brewery Co. Ltd to vary a premises licence in respect of the above premises.

To allow:-

Supply of Alcohol:- Sunday to Thursday 08:00 - 01:00  
Friday & Saturday 08:00 – 02:00  
Bank Holiday Sundays & Mondays, Christmas Eve  
& Boxing Day 08:00 – 02:00

Late Night Refreshment:- Sunday to Thursday 23:00 – 01:00  
Friday & Saturday 23:00 – 02:00  
Bank Holiday Sundays & Mondays, Christmas Eve  
& Boxing Day 23:00 – 02:00

Opening Hours:- Sunday to Thursday 08:00 – 01:30  
Friday & Saturday 08:00 – 02:30  
Bank Holiday Sundays & Mondays, Christmas Eve  
& Boxing Day 08:00 – 02:30

A copy of the application is attached as Appendix **A**.

A copy of the current premises licence is attached as Appendix **B**.

The Licensing Authority has made representations. These are attached as Appendix **C**.

Dyfed Powys Police have made representations. These are attached as Appendix **D**.

The remaining Responsible Authorities have not made representations in respect of the application.

Other persons have made representations in support of the application. These are attached as Appendix **E**.

DETAILED REPORT ATTACHED ?

NO



## IMPLICATIONS

I confirm that other than those implications which have been agreed with the appropriate Directors / Heads of Service and are referred to in detail below, there are no other implications associated with this report :

Signed: Mr Robin Staines

Head of Housing and Public Protection

Policy and Crime & Disorder	Legal	Finance	ICT	Risk Management Issues	Organisational Development	Physical Assets
N/A	NONE	NONE	NONE	NONE	NONE	NONE

## CONSULTATIONS

I confirm that the appropriate consultations have taken in place and the outcomes are as detailed below

Signed: Mr Robin Staines

Head of Housing and Public Protection

**1. Local Member(s):**

No local member involvement and therefore no consultation necessary.

**2. Community / Town Council:**

No Community / Town Council involvement and therefore no consultation necessary.

**3. Relevant Partners:**

The Responsible Authorities have been consulted regarding the application.

**4. Staff Side Representatives and other Organisations:**

There are no other organisations involved and therefore no consultation necessary.

**Section 100D Local Government Act, 1972 – Access to Information**

List of Background Papers used in the preparation of this report:

**THESE ARE DETAILED BELOW**

Title of Document	File Ref No.	Locations that the papers are available for public inspection
Application Form and File Contents.	Drovers Arms Hotel, 106 Lammas Street, Carmarthen SA31 3AP.	Licensing Section, 3 Spilman Street, Carmarthen
Licensing Policy		Licensing Section, 3 Spilman Street, Carmarthen
National Guidance		Licensing Section, 3 Spilman Street, Carmarthen



Mae'r dudalen hon yn wag yn fwriadol



[Insert name and address of relevant licensing authority and its reference number (optional).]

CARMARTHENSHIRE COUNTY COUNCIL.

Application to vary a premises licence under the Licensing Act 2003

PLEASE READ THE FOLLOWING INSTRUCTIONS FIRST

Before completing this form please read the guidance notes at the end of the form. If you are completing this form by hand please write legibly in block capitals. In all cases ensure that your answers are inside the boxes and written in black ink. Use additional sheets if necessary.

You may wish to keep a copy of the completed form for your records.

We FELINFOEL BREWERY Co LTD.

(Insert name(s) of applicant)

being the premises licence holder, apply to vary a premises licence under section 34 of the Licensing Act 2003 for the premises described in Part 1 below

Premises licence number	DONU-PRM-00182.
-------------------------	-----------------

Part 1 - Premises Details

Postal address of premises or, if none, ordnance survey map reference or description			
DROVERS ARMS HOTEL 106, LAMMAS STREET			
Post town	CARMARTHEN	Postcode	SA31 3AP
Telephone number at premises (if any)	01267 237646		
Non-domestic rateable value of premises	£ 11,250.00		

Part 2 - Applicant details

Daytime contact telephone number	01554 713357		
E-mail address (optional)	lesley.williams1@btconnect.com		
Current postal address if different from premises address	FARMERS ROW, FELINFOEL,		
Post town	LLANELLI	Postcode	SA14 8LB

K2

REGN No.
Social Care Health & Housing
03 MAR 2016
PUBLIC PROTECTION

Part 3 - Variation

Please tick as appropriate

Do you want the proposed variation to have effect as soon as possible?

Yes

No

If not, from what date do you want the variation to take effect?

DD	MM	YYYY

Please describe briefly the nature of the proposed variation (Please see guidance note 1)

THE PROPOSED VARIATION WOULD BE TO:-

- ① INCREASE THE SUPPLY OF ALCOHOL BY ONE HOUR THROUGHOUT THE WEEK AND ON SEASONAL VARIATIONS.
- ② INCLUDE LATE NIGHT REFRESHMENT THROUGHOUT THE WEEK AND ON SEASONAL VARIATIONS.
- ③ INCREASE THE HOURS THE PREMISES ARE OPEN TO THE PUBLIC BY ONE HOUR THROUGHOUT THE WEEK AND ON SEASONAL VARIATIONS.

If your proposed variation would mean that 5,000 or more people are expected to attend the premises at any one time, please state the number expected to attend:

N/A.
------

**Part 4 Operating Schedule**

Please complete those parts of the Operating Schedule below which would be subject to change if this application to vary is successful.

**Provision of regulated entertainment**

**Please tick all that apply**

- a) plays (if ticking yes, fill in box A)
- b) films (if ticking yes, fill in box B)
- c) indoor sporting events (if ticking yes, fill in box C)
- d) boxing or wrestling entertainment (if ticking yes, fill in box D)
- e) live music (if ticking yes, fill in box E)
- f) recorded music (if ticking yes, fill in box F)
- g) performances of dance (if ticking yes, fill in box G)
- h) anything of a similar description to that falling within (e), (f) or (g) (if ticking yes, fill in box H)

**Provision of late night refreshment** (if ticking yes, fill in box I)

**Sale by retail of alcohol** (if ticking yes, fill in box J)

**In all cases complete boxes K, L and M**

A

Plays Standard days and timings (please read guidance note 6)			<u>Will the performance of a play take place indoors or outdoors or both – please tick</u> (please read guidance note 2)	Indoors	<input type="checkbox"/>
				Outdoors	<input type="checkbox"/>
				Both	<input type="checkbox"/>
Day	Start	Finish	<u>Please give further details here</u> (please read guidance note 3)		
Mon					
			<u>State any seasonal variations for performing plays</u> (please read guidance note 4)		
Tue					
			<u>Non standard timings. Where you intend to use the premises for the performance of plays at different times to those listed in the column on the left, please list</u> (please read guidance note 5)		
Wed					
Thur					
Fri					
Sat					
Sun					

B

Films Standard days and timings (please read guidance note 6)			<u>Will the exhibition of films take place indoors or outdoors or both – please tick</u> (please read guidance note 2)	Indoors	<input type="checkbox"/>
				Outdoors	<input type="checkbox"/>
				Both	<input type="checkbox"/>
Day	Start	Finish	<u>Please give further details here</u> (please read guidance note 3)		
Mon					
Tue			<u>State any seasonal variations for the exhibition of films</u> (please read guidance note 4)		
Wed					
Thur			<u>Non standard timings. Where you intend to use the premises for the exhibition of films at different times to those listed in the column on the left, please list</u> (please read guidance note 5)		
Fri					
Sat					
Sun					

A6

C

Indoor sporting events Standard days and timings (please read guidance note 6)			<u>Please give further details</u> (please read guidance note 3)
Day	Start	Finish	
Mon			<u>State any seasonal variations for indoor sporting events</u> (please read guidance note 4)
Tue			
Wed			
Thur			<u>Non standard timings. Where you intend to use the premises for indoor sporting events at different times to those listed in the column on the left, please list</u> (please read guidance note 5)
Fri			
Sat			
Sun			

D

Boxing or wrestling entertainments Standard days and timings (please read guidance note 6)			<u>Will the boxing or wrestling entertainment take place indoors or outdoors or both – please tick (please read guidance note 2)</u>	Indoors	<input type="checkbox"/>
Day	Start	Finish		Outdoors	<input type="checkbox"/>
				Both	<input type="checkbox"/>
Mon				<u>Please give further details here (please read guidance note 3)</u>	
Tue					
Wed			<u>State any seasonal variations for boxing or wrestling entertainment (please read guidance note 4)</u>		
Thur					
Fri			<u>Non standard timings. Where you intend to use the premises for boxing or wrestling entertainment at different times to those listed in the column on the left, please list (please read guidance note 5)</u>		
Sat					
Sun					

E

<b>Live music</b> <b>Standard days and timings</b> (please read guidance note 6)			<u>Will the performance of live music take place indoors or outdoors or both – please tick (please read guidance note 2)</u>	Indoors	<input type="checkbox"/>
				Outdoors	<input type="checkbox"/>
				Both	<input type="checkbox"/>
<b>Day</b>	<b>Start</b>	<b>Finish</b>			
Mon			<u>Please give further details here (please read guidance note 3)</u>		
Tue					
Wed			<u>State any seasonal variations for the performance of live music (please read guidance note 4)</u>		
Thur					
Fri			<u>Non standard timings. Where you intend to use the premises for the performance of live music at different times to those listed in the column on the left, please list (please read guidance note 5)</u>		
Sat					
Sun					



F

Recorded music Standard days and timings (please read guidance note 6)			<u>Will the playing of recorded music take place indoors or outdoors or both – please tick (please read guidance note 2)</u>	Indoors	<input type="checkbox"/>
				Outdoors	<input type="checkbox"/>
				Both	<input type="checkbox"/>
Day	Start	Finish	<u>Please give further details here (please read guidance note 3)</u>		
Mon					
			<u>State any seasonal variations for the playing of recorded music (please read guidance note 4)</u>		
Tue					
			<u>Non standard timings. Where you intend to use the premises for the playing of recorded music at different times to those listed in the column on the left, please list (please read guidance note 5)</u>		
Wed					
Thur					
Fri					
Sat					
Sun					

(A10)

G

Performances of dance Standard days and timings (please read guidance note 6)			<u>Will the performance of dance take place indoors or outdoors or both – please tick</u> (please read guidance note 2)	Indoors	<input type="checkbox"/>
Day	Start	Finish		Outdoors	<input type="checkbox"/>
Mon			<b><u>Please give further details here</u></b> (please read guidance note 3)	Both	<input type="checkbox"/>
Tue			<b><u>State any seasonal variations for the performance of dance</u></b> (please read guidance note 4)		
Wed			<b><u>Non standard timings. Where you intend to use the premises for the performance of dance at different times to those listed in the column on the left, please list</u></b> (please read guidance note 5)		
Thur					
Fri					
Sat					
Sun					

H

<b>Anything of a similar description to that falling within (e), (f) or (g)</b> Standard days and timings (please read guidance note 6)			Please give a description of the type of entertainment you will be providing		
Day	Start	Finish	<b>Will this entertainment take place indoors or outdoors or both – please tick</b> (please read guidance note 2)	Indoors	<input type="checkbox"/>
Mon			<b>Please give further details here</b> (please read guidance note 3)	Outdoors	<input type="checkbox"/>
				Both	<input type="checkbox"/>
Tue				<b>State any seasonal variations for entertainment of a similar description to that falling within (e), (f) or (g)</b> (please read guidance note 4)	
Wed					
Thur			<b>Non standard timings. Where you intend to use the premises for the entertainment of a similar description to that falling within (e), (f) or (g) at different times to those listed in the column on the left, please list</b> (please read guidance note 5)		
Fri					
Sat			<b>Non standard timings. Where you intend to use the premises for the entertainment of a similar description to that falling within (e), (f) or (g) at different times to those listed in the column on the left, please list</b> (please read guidance note 5)		
Sun					

A12

I

<b>Late night refreshment</b> Standard days and timings (please read guidance note 6)			<b>Will the provision of late night refreshment take place indoors or outdoors or both – please tick</b> (please read guidance note 2)	Indoors	<input checked="" type="checkbox"/>
				Outdoors	<input type="checkbox"/>
				Both	<input type="checkbox"/>
<b>Day</b>	<b>Start</b>	<b>Finish</b>	<b>Please give further details here</b> (please read guidance note 3)		
Mon	23.00	01.00			
Tue	23.00	01.00	<b>State any seasonal variations for the provision of late night refreshment</b> (please read guidance note 4) BANK HOLIDAY SUNDAY & MONDAY 23.00 - 02.00 CHRISTMAS EVE & BOXING DAY 23.00 - 02.00 NEW YEARS EVE 23.00 - 05.00		
Wed	23.00	01.00			
Thur	23.00	01.00	<b>Non standard timings. Where you intend to use the premises for the provision of late night refreshment at different times, to those listed in the column on the left, please list</b> (please read guidance note 5)		
Fri	23.00	02.00			
Sal	23.00	02.00	AS ABOVE.		
Sun	23.00	01.00			

J

<b>Supply of alcohol</b> Standard days and timings (please read guidance note 6)			<b>Will the supply of alcohol be for consumption – please tick</b> (please read guidance note 7)	On the premises	<input type="checkbox"/>
				Off the premises	<input type="checkbox"/>
				Both	<input checked="" type="checkbox"/>
Day	Start	Finish			
Mon	08.00	01.00	<p><b>State any seasonal variations for the supply of alcohol</b> (please read guidance note 4)</p> <p>BANK HOLIDAY SUNDAY + MONDAY 08.00 – 02.00</p> <p>CHRISTMAS EVE 08.00 – 02.00</p> <p>BOXING DAY 08.00 – 02.00</p> <p>NEW YEARS EVE - FROM THE END OF PERMITTED HOURS ON N.Y.E TO THE START OF PERMITTED HOURS THE FOLLOWING DAY. (AS PER EXISTING LICENCE).</p> <p><b>Non-standard timings. Where you intend to use the premises for the supply of alcohol at different times to those listed in the column on the left, please list</b> (please read guidance note 5)</p> <p>THE EARLY START IS TO ACCOMMODATE TELEVISED SPORTING EVENTS (AS PER EXISTING LICENCE)</p> <p>AS ABOVE.</p>		
Tue	08.00	01.00			
Wed	08.00	01.00			
Thur	08.00	01.00			
Fri	08.00	02.00			
Sat	08.00	02.00			
Sun	08.00	01.00			

K

**Please highlight any adult entertainment or services, activities, other entertainment or matters ancillary to the use of the premises that may give rise to concern in respect of children** (please read guidance note 8).

A14

L

Hours premises are open to the public Standard days and timings (please read guidance note 6)			State any seasonal variations (please read guidance note 4)		
Day	Start	Finish	<p>BANK HOLIDAY SUNDAY &amp; MONDAY 08:00 - 02:30</p> <p>CHRISTMAS EVE      08:00 - 02:30</p> <p>BOXING DAY            08:00 - 02:30</p> <p>NEW YEARS EVE - FROM THE END OF PERMITTED HOURS ON N.Y.E TO THE START OF PERMITTED HOURS THE FOLLOWING DAY (AS PER EXISTING LICENCE)</p> <p><u>Non standard timings. Where you intend the premises to be open to the public at different times from those listed in the column on the left, please list (please read guidance note 5)</u></p> <p>THE EARLY START IS TO ACCOMMODATE TELEVISED SPORTING EVENTS. (AS PER EXISTING LICENCE)</p> <p>AS ABOVE.</p>		
Mon	08:00	01:30			
Tue	08:00	01:30			
Wed	08:00	01:30			
Thur	08:00	01:30			
Fri	08:00	02:30			
Sat	08:00	02:30			
Sun	08:00	01:30			

Please identify those conditions currently imposed on the licence which you believe could be removed as a consequence of the proposed variation you are seeking.

- I have enclosed the premises licence
- I have enclosed the relevant part of the premises licence

Please tick as appropriate

If you have not ticked one of these boxes, please fill in reasons for not including the licence or part of it below

Reasons why I have not enclosed the premises licence or relevant part of premises licence.

**M**

Describe any additional steps you intend to take to promote the four licensing objectives as a result of the proposed variation:

**a) General – all four licensing objectives (b, c, d and e) (please read guidance note 9)**

AS PER EXISTING LICENCE

**b) The prevention of crime and disorder**

AS PER EXISTING LICENCE

**c) Public safety**

AS PER EXISTING LICENCE

**d) The prevention of public nuisance**

AS PER EXISTING LICENCE

**e) The protection of children from harm**

AS PER EXISTING LICENCE



Checklist:

Please tick to indicate agreement

- I have made or enclosed payment of the fee.
- I have sent copies of this application and the plan to responsible authorities and others where applicable.
- I understand that I must now advertise my application.
- I have enclosed the premises licence or relevant part of it or explanation.
- I understand that if I do not comply with the above requirements my application will be rejected.

IT IS AN OFFENCE, LIABLE ON SUMMARY CONVICTION TO A FINE NOT EXCEEDING LEVEL 5 ON THE STANDARD SCALE, UNDER SECTION 158 OF THE LICENSING ACT 2003, TO MAKE A FALSE STATEMENT IN OR IN CONNECTION WITH THIS APPLICATION.

Part 5 – Signatures (please read guidance note 10)

Signature of applicant (the current premises licence holder) or applicant’s solicitor or other duly authorised agent (please read guidance note 11). If signing on behalf of the applicant, please state in what capacity.

Signature	<i>W Williams</i>
Date	<i>25<sup>th</sup> February 2016.</i>
Capacity	<i>TIED ESTATE AREA MANAGER.</i>

Where the premises licence is jointly held, signature of 2nd applicant (the current premises licence holder) or 2nd applicant’s solicitor or other authorised agent (please read guidance note 12). If signing on behalf of the applicant, please state in what capacity.

Signature	
Date	
Capacity	

Contact name (where not previously given) and address for correspondence associated with this application (please read guidance note 13)

*WESLEY WILLIAMS  
FELINFOEL BREWERY CO LTD  
FARMERS ROW  
FELINFOEL*

Post town	<i>Llanelli</i>	Post code	<i>SA14 8LB</i>
Telephone number (if any)	<i>01554 77357</i>		
If you would prefer us to correspond with you by e-mail, your e-mail address (optional)			
<i>lesley.williams1@btconnect.com</i>			

(B1)



## PREMISES LICENCE LICENSING ACT 2003

Premises licence number

**No: OONU-PRM-00182**

### Part 1 - Premises details

<b>Postal address of premises, or if none, ordnance survey map reference or description</b>
<b>Address</b>  Drovers Arms Hotel 106 Lammas Street Carmarthen Carmarthenshire SA31 3AP
<b>Telephone number</b> 0267 237646

<b>Where the licence is time limited the dates</b>  This Premises Licence is not time limited.
--

<b>Licensable activities authorised by the licence</b>  <ul style="list-style-type: none"> <li>▪ Sale by retail of alcohol.</li> <li>▪ Regulated Entertainment (As specified overleaf).</li> <li>▪ Late night refreshment.</li> </ul> <p>The above activities may only be conducted within the areas of the premises licensed for those specific activities, as shown on the plan attached to this licence as Annex 4.</p>
--

**Bruce McLernon B.A., C.Q.S.W., D.M.S.**  
Cyfarwyddwr Gofal Cymdeithasol, Iechyd a Thai, Is-Adran Diogelu'r Cyhoedd, 3 Heol Spilman, Caerfyrddin, SA31 1LE.  
Director of Social Care, Health & Housing, Public Protection Division, 3 Spilman Street, Carmarthen, SA31 1LE.

Tudalen 26

(B2)

The Times The Licence Authorises The Carrying Out Of  
Licensable Activities

**Supply of alcohol**

Standard days and timings

Sunday to Thursday 08:00 - 00:00  
Friday & Saturday 08:00 - 01:00

Seasonal Variations

Bank Holiday Sundays & Mondays 08:00 - 01:00  
Christmas Eve 08:00 - 01:00  
Boxing Day 08:00 - 01:00

New Years Eve - from the end of permitted hours on New Years Eve to the start of permitted hours on the following day.

Non Standard timings.

Pre booked private functions finish 01:00.  
The early start is to accommodate televised sporting events

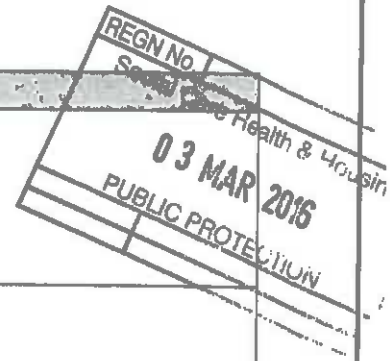

**Films**

Standard days and timings

Monday to Friday 10:00 - 23:00  
Saturday & Sunday 19:00 - 23:00

Indoors in the areas licensed at the premises for this activity.

Further details

Films may accompany Karaoke but also for training, meetings, seminars etc in Drawing Room.

Seasonal Variations

New Years Eve finish 00:30

Non Standard timings

Pre-booked private functions finish 00:00

**Live Music**

Standard days and timings

Monday to Sunday 19:00 - 23:00

Indoors in the areas licensed at the premises for this activity.

Further details

Live music on occasional basis

Seasonal Variations

New Year's Eve 19:00 - 00:30

Non Standard timings.

Pre-booked private functions 19:00 - 00:00

83

REGN No. /  
Social  
Health & Housing  
03 MAR 2016  
PUBLIC PROTECTION

<b>Recorded Music</b>
<u>Standard days and timings</u> <b>Monday to Sunday 19:00 - 23:00</b>
<b>Indoors in the areas licensed at the premises for this activity.</b>
<u>Further details</u> <b>DJ on occasional basis in Dining Room area</b>
<u>Seasonal Variations</u> <b>New Year's Eve 19:00 - 00:30</b>

<b>Anything of a similar description to live music, recorded music or performances of dance</b>
<u>Standard days and timings</u> <b>Monday to Sunday 19:00 - 23:00</b>
<b>Indoors in the areas licensed at the premises for this activity.</b>
<u>Further details</u> <b>Karaoke on occasional basis only</b>
<u>Seasonal Variations</u> <b>New Years Eve 19:00 - 00:30</b>
<u>Non Standard timings</u> <b>Pre booked private functions 19:00 - 00:00</b>

<b>Provision of facilities for dancing</b>
<u>Description of the Facilities for Dancing</u> <b>Possibility of dancing in Dining Room when functions arise.</b>
<u>Standard days and timings</u> <b>Monday to Sunday 19:00 - 23:00</b>
<b>Indoors in the areas licensed at the premises for this activity.</b>
<u>Seasonal Variations</u> <b>New Year's Eve 19:00 - 00:30</b>
<u>Non Standard timings.</u> <b>Pre-Booked Private Functions 19:00 - 00:00</b>

B4

**Late Night Refreshment**

**Standard days and timings**  
Sunday to Thursday 23:00 - 00:00  
Friday & Saturday 23:00 - 01:00

**Indoors in the areas licensed at the premises for this activity.**

**Further details**  
**Hot food and beverages**

**Seasonal Variations**  
**New Years Eve 23:00 - 05:00**

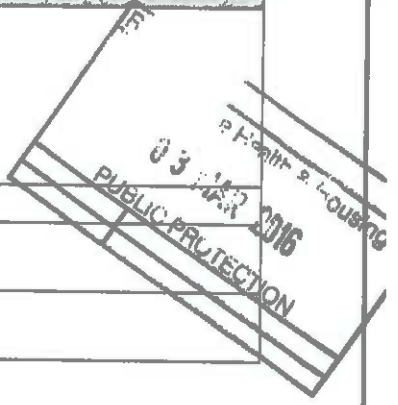

**The opening hours of the premises**

**Standard days and timings**  
Sunday to Thursday 08:00 - 00:30  
Friday & Saturday 08:00 - 01:30

**Seasonal Variations**  
**Bank Holiday Sundays & Mondays 08:00 - 01:30**  
**Christmas Eve 08:00 - 01:30**  
**Boxing Day 08:00 - 01:30**

**New Years Eve - from the end of permitted hours on New Years Eve to the start of permitted hours on the following day.**

**In relation to the morning on which summertime begins, where the terminal hour specified in the licence is 1am or later, it shall be extended by one hour.**

**Where the licence authorises supplies of alcohol whether these are on and or off supplies**

**This premises licence authorises the supply of alcohol for consumption both on and off the premises.**

85.

**Part 2**

Name, (registered) address, telephone number and email (where relevant) of holder of premises licence

Name: **Felinfoel Brewery Company Limited**

Address: **Farmers Row  
Felinfoel  
Llanelli  
SA14 8LB**

Telephone number: **01554 773357**  
Email:

REGN No. /  
Social Care Health & Ho  
**03 MAR 2016**  
PUBLIC PROTECTION

Registered number of holder, for example company number, charity number (where applicable)

**90279**

Name, address and telephone number of designated premises supervisor where the premises licence authorises for the supply of alcohol

Name: **Mr Raymond Josh Clarke**

Address: 

Telephone number:  
Email:

Personal licence number and issuing authority of personal licence held by designated premises supervisor where the premises licence authorises for the supply of alcohol

Personal Licence Number: **OONU-IND-01974**

Issuing Authority: **Carmarthenshire County Council**

Dated: **25 February 2015**

Signed: **pp. K Smith**  
**Head of Housing & Public Protection.**

Social Care Health  
03 MAR 2003  
PUBLIC PROTECTION  
Annex 1  
Bb

**Mandatory conditions.**

**Mandatory conditions where licence authorises supply of alcohol.**

- a. No supply of alcohol may be made under the premises licence-
  - i. at a time when there is no designated premises supervisor in respect of the premises licence, or
  - ii. at a time when the designated premises supervisor does not hold a personal licence or his personal licence is suspended.
- b. Every supply of alcohol under the premises licence must be made or authorised by a person who holds a personal licence.

**Mandatory condition where licence authorises the exhibition of films**

- a. Where a premises licence authorises the exhibition of films, it is a condition that the admission of children to the exhibition of any film is to be restricted in accordance with any recommendation made by the British Board of Film Classification.
- b. Where the relevant licensing authority has notified the holder of the licence that this subsection applies to the film in question, admission of children must be restricted in accordance with any recommendation made by that licensing authority.
- c. In this section—
  - i. "children" means persons aged under 18; and
  - ii. "film classification body" means the person or persons designated as the authority under section 4 of the Video Recordings Act 1984 (c. 39) (authority to determine suitability of video works for classification).

**Mandatory Licensing Conditions**

**Sections 19A and 73A of the Licensing Act 2003**

- 1. —
  - (1) The responsible person must ensure that staff on relevant premises do not carry out, arrange or participate in any irresponsible promotions in relation to the premises.
  - (2) In this paragraph, an irresponsible promotion means any one or more of the following activities, or substantially similar activities, carried on for the purpose of encouraging the sale or supply of alcohol for consumption on the premises –

03 MAR 2016

PUBLIC PROTECTION

B7

- (a) games or other activities which require or encourage, or are designed
  - (b) to require or encourage, individuals to –
    - (i) drink a quantity of alcohol within a time limit (other than to drink alcohol sold or supplied on the premises before the cessation of the period in which the responsible person is authorised to sell or supply alcohol), or
    - (ii) drink as much alcohol as possible (whether within a time limit or otherwise);
  - (c) provision of unlimited or unspecified quantities of alcohol free or for a fixed or discounted fee to the public or to a group defined by a particular characteristic in a manner which carries a significant risk of undermining a licensing objective;
  - (d) provision of free or discounted alcohol or any other thing as a prize to encourage or reward the purchase and consumption of alcohol over a period of 24 hours or less in a manner which carries a significant risk of undermining a licensing objective;
  - (e) selling or supplying alcohol in association with promotional posters or flyers on, or in the vicinity of, the premises which can reasonably be considered to condone, encourage or glamorise anti-social behaviour or to refer to the effects of drunkenness in any favourable manner.
  - (f) Dispensing alcohol directly by one person into the mouth of another (other than where that other person is unable to drink without assistance by reason of a disability).
2. The responsible person must ensure that free potable water is provided on request to customers where it is reasonably available.
3. —
- (1) The premises licence holder or club premises certificate holder must ensure that an age verification policy is adopted in respect of the premises in relation to the sale or supply of alcohol.
  - (2) The designated premises supervisor in relation to the premises must ensure that the supply of alcohol at the premises is carried out in accordance with the age verification policy.
  - (3) The policy must require individuals who appear to the responsible person to be under 18 years of age (or such older age as may be specified in the policy) to produce on request, before being served alcohol, identification bearing their photograph, date of birth and either -
    - a) a holographic mark, or
    - b) an ultraviolet feature.



REGN No. 1  
Social Care Health &  
88  
03 MAR 2013  
PUBLIC PROTECTION

4. The responsible person must ensure that –
- (a) where any of the following alcoholic drinks is sold or supplied for consumption on the premises (other than alcoholic drinks sold or supplied having been made up in advance ready for sale or supply in a securely closed container) it is available to customers in the following measures –
    - (i) beer or cider: ½ pint;
    - (ii) gin, rum, vodka or whisky: 25 ml or 35 ml; and
    - (iii) still wine in a glass: 125 ml; and
  - (b) these measures are displayed in a menu, price list or other printed material which is available to customers on the premises; and
  - (c) where a customer does not in relation to a sale of alcohol specify the quantity of alcohol to be sold, the customer is made aware that these measures are available.

Licensing Act 2003 (Mandatory Conditions) Order 2014

5. (1) A relevant person shall ensure that no alcohol is sold or supplied for consumption on or off the premises for a price which is less than the permitted price.

- (2) For the purposes of the condition set out in paragraph (1) -
- (a) “duty” is to be construed in accordance with the Alcoholic Liquor Duties Act 1979(a);
  - (b) “permitted price” is the price found by applying the formula—

$$P = D + (D \times V)$$

where—

- (i) P is the permitted price,
- (ii) D is the amount of duty chargeable in relation to the alcohol as if the duty were charged on the date of the sale or supply of the alcohol, and
- (iii) V is the rate of value added tax chargeable in relation to the alcohol as if the value added tax were charged on the date of the sale or supply of the alcohol;

(c) “relevant person” means, in relation to premises in respect of which there is in force a premises licence—

- (i) the holder of the premises licence,
- (ii) the designated premises supervisor (if any) in respect of such a licence, or
- (iii) the personal licence holder who makes or authorises a supply of alcohol under such a licence;

BA

REGN No. / Social Care Health & Housing  
**03 MAR 2016**  
PUBLIC PROTECTION

(d) "relevant person" means, in relation to premises in respect of which there is in force a club premises certificate, any member or officer of the club present on the premises in a capacity which enables the member or officer to prevent the supply in question; and

(e) "value added tax" means value added tax charged in accordance with the Value Added Tax Act 1994(b).

(3) Where the permitted price given by Paragraph (b) of paragraph 2 would (apart from this paragraph) not be a whole number of pennies, the price given by that sub-paragraph shall be taken to be the price actually given by that sub-paragraph rounded up to the nearest penny.

(4)— (1) Sub-paragraph (2) applies where the permitted price given by Paragraph (b) of paragraph 2 on a day ("the first day") would be different from the permitted price on the next day ("the second day") as a result of a change to the rate of duty or value added tax.

(2) The permitted price which would apply on the first day applies to sales or supplies of alcohol which take place before the expiry of the period of 14 days beginning on the second day.

**Annex 2**

**Conditions Consistent with the Operating Schedule**

a) **General – all four licensing objectives (b, c, d, e)**

[Empty rectangular box]

b) **The prevention of crime and disorder**

1. **No reduced price promotions on alcoholic drinks.**
2. **Encourage customers to use safe transport via taxis when necessary.**
3. **Regular consultations with neighbouring properties regarding any issues.**
4. **No open bottles or glasses to be taken out.**
5. **In respect of International Sporting Events within non-standard timings the Police will ask that the events included should be as follows:**
  - (a) **Rugby World Cup**
  - (b) **Football World Cup**
  - (c) **European Rugby and Football competitions**
  - (d) **Olympic Games**
  - (e) **European and Commonwealth Athletics**
  - (f) **Cricket Internationals and World Cup games**
  - (g) **Major World Boxing matches**
  - (h) **American Football final.**

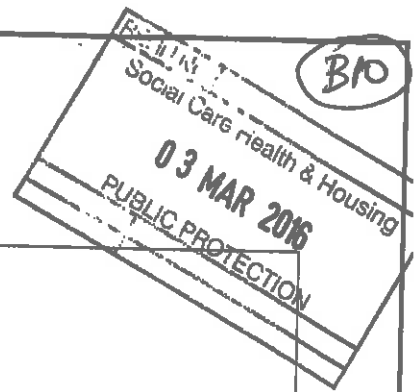

**c) Public Safety**

1. Toughened glasses in use.
2. Ensure all exits remain unobstructed.
3. Maintain first aid kit.
4. Plastic glasses available for children and outside area on request.
5. Adequate seating provided.
6. Numbers to be limited on busy occasions e.g. New Year's Eve.

**d) The prevention of public nuisance**

1. No can/bottle waste to be sorted out of hours
2. No deliveries received out of hours.
3. Music volume to be strictly controlled and monitored by DPS and staff re, residents and neighbours.
4. Notices in place requesting customers leave quietly to respect the residents and neighbours needs.
5. A terminal hour of 22:30 in any outside location/beer garden within the boundaries of the premises, for the consumption of alcohol.
6. After this time only those persons who wish to smoke be allowed within this area.

**e) The protection of children from harm**

1. Children permitted when accompanied by a responsible adult.
2. No adult entertainment permitted throughout.
3. Proof of age required for under 21's - validate, passport or driving licence.
4. No one under 18 to play AWP machines, no one under 16 to purchase tobacco products (subject to change October 2007).

Annex 2 Cont.

**Embedded Conditions**

**On licence**

The licence restrictions that relate to the sale of alcohol do not prohibit:

- (a) during the first twenty minutes after the above hours, the taking of the alcohol from the premises unless the alcohol is supplied or taken in an open vessel;
- (b) during the first thirty minutes after the above hours the consumption of the alcohol on the premises by persons taking meals there if the alcohol was supplied for consumption as ancillary to the meals;

B11

No. 1  
Social Care Health & Ho  
03 MAR 2016  
PUBLIC PROTECTION

- (c) consumption of the alcohol on the premises or the taking of sale or supply of alcohol to any person residing in the licensed premises;
- (d) the ordering of alcohol to be consumed off the premises, or the dispatch by the vendor of the alcohol so ordered;
- (e) the sale of alcohol to a trader or club for the purposes of the trade or club;
- (f) the sale or supply of alcohol to any canteen or mess, being a canteen in which the sale or supply of alcohol is carried out under the authority of the Secretary of State or an authorised mess of members of Her Majesty's naval, military or air forces;
- (g) the taking of alcohol from the premises by a person residing there; or
- (h) the supply of alcohol for consumption on the premises to any private friends of a person residing there who are bona fide entertained by him at his own expense, or the consumption of alcohol by persons so supplied; or
- (i) the supply of alcohol for consumption on the premises to persons employed there for the purposes of the business carried on by the holder of the licence, or the consumption of liquor so supplied, if the liquor is supplied at the expense of their employer or of the person carrying on or in charge of the business on the premises.

**Access for children (Premises without children's certificate)**

**Children in bars**

No person under fourteen shall be in the bar of the licensed premises during the permitted hours unless one of the following applies:

- (a) He is the child of the holder of the premises licence.
- (b) He resides in the premises, but is not employed there.
- (c) He is in the bar solely for the purpose of passing to or from some part of the premises, which is not a bar and to or from which there is no other convenient means of access or egress.
- (d) The bar is in railway refreshment rooms or other premises constructed, fitted and intended to be used bona fide for any purpose to which the holding of the licence is ancillary.

In this condition "bar" includes any place exclusively or mainly used for the consumption of intoxicating liquor. But an area is not a bar when it is usual for it to be, and it is, set apart for the service of table meals and alcohol is only sold or supplied to persons as an ancillary to their table meals.

**Annex 3**

**Conditions attached after a hearing by the Licensing Authority.**

N/A

**Annex 4 – Containing plans of the licensed premises is attached.**

NOT TO SCALE  
 DATE: 26/9/07  
 LICENCE NUMBER:  
 OONU - PRM - 001/2  
 PAGE 1 OF 1  
 LICENCED AREA(S)  
 SALE OF ALCOHOL  
 REGULATED ENTERTAINMENT

REGN No. [ ]  
 Social Care Health & Housing  
 03 MAR 2016  
 PUBLIC PROTECTION  
 STAFF DOOR TO YARD/STORE  
 HOP UP TO WOODEN  
 STAIRS TO SECOND FLOOR

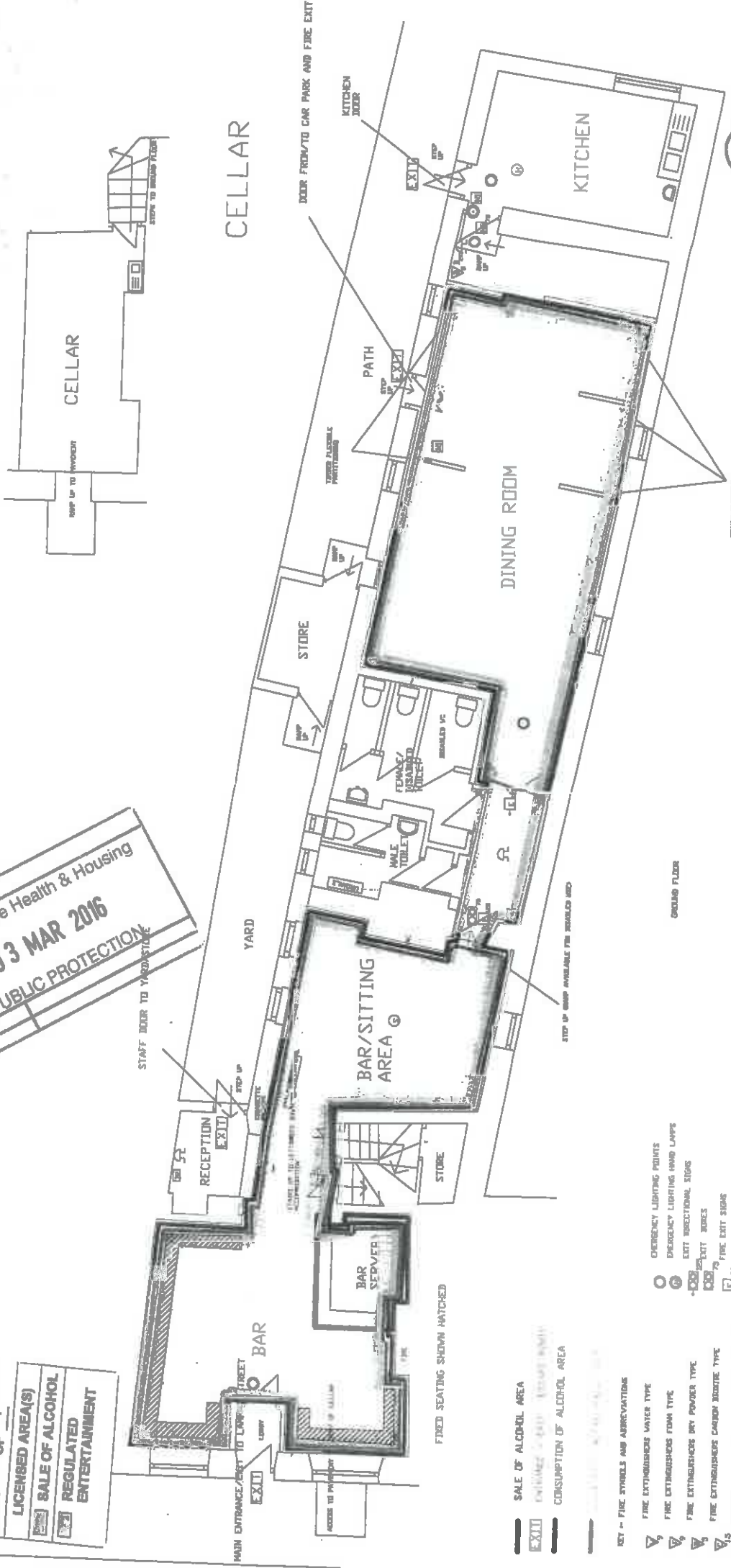

B12

- KEY - FIRE SYMBOLS AND ABBREVIATIONS
- ▽ FIRE EXTINGUISHERS WATER TYPE
  - ▽ FIRE EXTINGUISHERS FOAM TYPE
  - ▽ FIRE EXTINGUISHERS DRY POWDER TYPE
  - ▽ FIRE EXTINGUISHERS CARBON DIOXIDE TYPE
  - ▽ FIRE EXTINGUISHERS VAPORISING LIQUID TYPE
  - ALARM CALL POINTS
  - FIRE ALARM SERVICES
  - FIRE DETECTION HEAT
  - FIRE DETECTION SMOKE
  - FIRE ALARM INDICATOR PANEL
  - EMERGENCY LIGHTING POINTS
  - EMERGENCY LIGHTING HAND LAMPS
  - EXIT DIRECTIONAL SIGNS
  - EXIT SIGNS
  - FIRE EXIT SIGNS
  - FIRE EXIT DIRECTIONAL SIGNS
  - GENERAL FIRE NOTICES
  - NOTICES ON DOORS
  - FIRE EXIT SLIP/PUSH TO OPEN
  - FIRE EXIT REEP CLEAR NOTICES
  - FIRE REEP KEEP SHUT NOTICES
- SALE OF ALCOHOL AREA  
 CONSUMPTION OF ALCOHOL AREA  
 FIXED SEATING SHOWN HATCHED  
 YARD  
 STORE  
 BAR  
 BAR SEWER  
 RECEPTION  
 BAR/SITTING AREA  
 TOILET  
 FEMALE/UNASSIGNED TOILET  
 MALE TOILET  
 BOILER VC  
 STORE  
 DINING ROOM  
 KITCHEN  
 KITCHEN DOOR  
 DOOR FROM TO CAR PARK AND FIRE EXIT  
 PATH  
 CELLAR  
 CELLAR  
 CELLAR

**ASTLEY SAMUEL LEEDER**  
 BUILDING SURVEYING & ARCHITECTURAL SERVICES

CLIENT :  
 THE FELINFDEL BREWERY COMPANY LTD.  
 FELINFDEL LLANELLI

PROJECT :  
 LAYOUT PLAN OF LICENCED PREMISES

DRAWING TITLE :  
 GROUND FLOOR AND CELLAR OF THE DROVER'S ARMS, LAMMAS STREET, CARMARTHEN.

Drawn by : SHD  
 Date : 06/2015  
 Drawn by : JDA/LS/CARM/1



Eich cyf / Your ref:

Fy nghyf / My ref:

Dyddiad / Date: 29<sup>th</sup> March 2016

Gofynner am / Please ask for:

Llinell Uniongyrchol / Direct Line:

E-bost / E-mail:

Emyr Jones

(01267) 228717

publicprotection@carmarthenshire.gov.uk

Head of Housing and Public Protection  
Carmarthenshire County Council  
3 Spilman Street,  
Carmarthen  
SA31 1LE

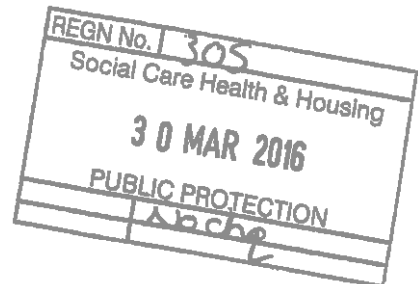

Dear Sir,

**RE: Application to vary a Premises Licence  
The Drovers Arms, Lammas Street, Carmarthen.  
Application Date 03/03/16**

Further to the receipt of the above application, the Licensing Authority make the following representations:

- a) **Previous Enforcement Action / Prosecutions**  
Following a joint visit by Police and licensing officers to the premises on the 20<sup>th</sup> of July 2014, when the premises were found to be operating beyond the permitted hours as set out in the licence, the designated premises supervisor was warned regarding the breach of licence conditions.
- b) **Complaints.**  
There have been no complaints received by the licensing authority in relation to these premises.
- c) **Responsible Authority Referrals.**  
The licensing authority has not received any referrals from the other responsible authorities in relation to the above premises.
- d) **Relevant Sections of the Statutory Guidance.**

The Licensing Authority believes that the following sections of the Statutory Guidance are relevant to this licence application: - Section 1 Introduction, Section 2 relating to The Licensing Objectives, Section 5 relating to Premises licences, Section 8 relating to Applications for Premises Licences, in particular paragraphs 8.33 to 8.41 and Section 10 relating to Licence Conditions.

- e) **Relevant Sections of the Local Licensing Policy.**

Robin Staines BA (Hons.), MA, MCIH

Pennaeth Tai & Dlogelu'r Cyhoedd

Adran Cymunedau

3 Heol Spilman, Caerfyrddin, SA31 1LE.

Tŷ Elwyn, Tŷ Aelwyd, SA31 3AP

Neuadd y Dref, Heol Iscennen, Rhydaman, SA18 3BE.

Head of Housing & Public Protection

Department for Communities

3 Spilman Street, Carmarthen, SA31 1LE.

Tŷ Elwyn, Llanelli, SA15 3AP.

Town Hall, Iscennen Road, Ammanford, SA18 3BE.



BUDDSODDWYR  
MEWN POBL

INVESTORS  
IN PEOPLE

The Licensing Authority believes that the following sections of Carmarthenshire's Licensing Policy are relevant to this licence application:- Section 3 Fundamental principles, Section 4 Conditions of Licence, Sections 5 – 9 relating to The Licensing Objectives, in particular paragraphs 5.1-5.5, 5.10, 6.1-6.4, 6.12 and Section 11 relating to Licensing Hours. C2

f) Proposed Operating Schedule.

The operating schedule submitted as part of the variation application indicates that the applicant proposes to operate in accordance with the conditions attached to the existing premises licence.

The Dyfed Powys Police have submitted representations objecting to the variation application as the premises are situated in Lammas Street Carmarthen, where there has been an increase in alcohol related crime and disorder since 2012.

Lammas Street Carmarthen is highlighted in the Council's Licensing Policy at paragraph 6.12 as a hot spot of alcohol related crime and disorder and as a result applicants are advised to pay special attention to measures aimed at preventing Crime and Disorder.

The licensing policy at paragraphs 5.1 to 5.5, advises applicants as follows :-

*5.1 Applicants for new premises licences and those seeking variation of existing licences/permissions are advised to demonstrate how they intend to promote the four licensing objectives.*

*5.2 In order to do this applicants are advised to carry out a comprehensive and detailed assessment which should cover, amongst other things:*

- a) The scope and nature of the licensable activities to be carried out.*
- b) The duration of such activities.*
- c) The nature and location of the premises in which the activities are to take place (this may include reference to beer gardens, smoking shelters or any other open areas forming part of the premises, or used by the premises for the carrying on of licensable activities and/or consumption of alcohol).*
- d) The nature and location of other premises in the vicinity and their occupants.*
- e) The skills and knowledge levels of persons engaged in carrying out those activities.*

*5.3 The Licensing Authority advises that such an assessment should identify issues which could lead to the licensing objectives being undermined.*

*5.4 The Licensing Authority advises that such an assessment, and its conclusions, be incorporated within, or be annexed to, the operating schedule, which forms part of the application. Where an applicant chooses not to submit a risk assessment they are advised instead to provide a statement explaining why in their opinion one is not needed.*

*5.5 The Licensing Authority advises that the operating schedule sets out in detail the control measures the applicant intends to put in place to deal with the risks identified in the assessment.*

3

In view of the nature of the application, the location of the premises and the subsequent representations submitted by the Dyfed Powys Police, the licensing authority believes it would be appropriate to request that the applicants provide the authority with a copy of the assessment detailed above, for consideration prior to the matter being referred to a sub committee for determination.

These representations have been prepared on the 29<sup>th</sup> of March 2016 with the benefit of viewing the original application and representations from the Police.

I would be grateful if the applicant could contact me to discuss the above representations at the earliest opportunity and certainly prior to the application being referred to a Licensing Sub Committee hearing for determination.

Yours faithfully,



**Mr E O R Jones**  
**Principal Licensing Officer**





# Heddlu • Police DYFED-POWYS

*Diogelwch ein Cymuned - Safeguarding our Community*

Eich cyf. / Your ref.

Ein cyf. / Our ref.

Gofynnwch am:/Please ask for:

PR220vary//MP

## Gorsaf yr Heddlu Llanelli Llanelli Police Station

Wauriaryrafon, Llanelli, Sir Gaerfyrddin, SA15 3AD.  
Wauriaryrafon, Llanelli, Carmarthenshire, SA15 3AD.

• Ffôn/Tel : **101 - Llanelli**  
**01267 222020** y tu allan I ardal Dyfed-Powys  
**01267 222020** if outside the Dyfed-Powys area

• Ffacs/Fax : **01554 741118**  
• Wefan/Web : **www.dyfed-powys.police.uk**

(DI)

Mike Price  
Divisional Licensing Officer  
Telephone 101 extension 26464  
email [mike.price@dyfed-powys.pnn.police.uk](mailto:mike.price@dyfed-powys.pnn.police.uk)

Mr EOR Jones  
Principal Licensing Officer  
Carmarthenshire County Council  
3 Spilman Street  
Carmarthen  
SA31 1LE

Felinfoel Brewery Company Limited  
Farmers Row  
Felinfoel  
Llanelli  
Carmarthenshire  
SA14 8LB

Tuesday 22<sup>nd</sup>. March 2016

Dear Sir,

**Re: Variation of Premises Licence – Drovers Arms Hotel, 106 Lammas Street,  
Carmarthen. SA31 3AP**

**Applicant – Felinfoel Brewery Company Limited  
Date completed application received – 03/03/16**

With reference to the above application for the Variation of a Premises Licence the following Licensing Activities are applied for.

Extend the Supply of Alcohol on and off the premises.

Sunday to Thursday 08.00 to 01.00.  
Friday and Saturday 08.00 to 02.00

Prif Gwnstabi • **Mr. Simon Prince** • Chief Constable

Buddsoddwyr  
Mewn Pobl

Investors  
in People



Mae Heddlu Dyfed-Powys yn croesawu gohableeth yn y Gymraeg neu'r Saesneg.  
Dyfed-Powys Police welcomes correspondence in either Welsh or English.

101  
Tudalen 41

52

With the premises open to the public.

Sunday to Thursday 08.00 to 01.30  
Friday and Saturday 08.00 to 02.30

Late Night Refreshment

Sunday to Thursday 23.00 to 01.00  
Friday and Saturday 23.00 to 02.00

Seasonal Variations.

Supply of Alcohol

Bank Holiday Sunday and Mondays, Christmas Eve and Boxing Day 08.00 to 02.00.  
New Year's Eve as per de regulation order.

With the premises open to the public on the days applied for 08.00 to 02.00.

No Non Standard Timings.

The Carmarthenshire Division of the Dyfed Powys Police will object to the above application on the following grounds.

Lammas Street has been identified as a 'Hot Spot' within Carmarthen town centre for a number of years in respect of alcohol related crime and disorder and anti-social behaviour.

During the recent review of the Carmarthenshire County Council Licensing Policy, levels of alcohol related crime and disorder and anti-social behaviour were shown to have increased within Lammas Street since the previous review in 2012.

As a result of this increase the Police have in their response to the consultation in respect of the Licensing Policy made an application that the local authority adopts a Cumulative Impact Policy for Lammas Street.

Evidence in support of the objection will be provided in due course.

Yours Sincerely

*Mike Price*

Divisional Licensing Officer

**From:** Price Mike [mike.price@Dyfed-Powys.pnn.police.uk]  
**Sent:** 12 April 2016 15:18  
**To:** SCH Licensing  
**Subject:** MG11 re Bank Holiday 6th April  
**Attachments:** MG11 re Bank Holiday 6th April.doc

Andrew,

Can the attached statement be included as evidence for the Drivers please.

Mike

#### E-MAIL CONFIDENTIALITY STATEMENT

This e-mail and any files transmitted with it are not necessarily the view of Dyfed-Powys Police. It is intended only for the person or entity named above. If you have received this e-mail in error please notify the originator and erase this e-mail from your system. If you are not the intended recipient or the employer or agent responsible for delivering it to the intended recipient, you are hereby notified that any use, review, dissemination, distribution or copying of the e-mail is strictly prohibited. This e-mail and any files transmitted within it have been checked for all known viruses. The recipient should still check the e-mail and any attachments for the presence of viruses, as Dyfed-Powys Police accepts no liability for any damage caused by any virus transmitted by this e-mail.

#### DATGANIAD CYFRINACHEDD E BOST

Nid yw'r e-bost hwn nag unrhyw ffeiliau a drosglwyddir gydag ef o angenrheidrwydd yn adlewyrchu barn Heddlu Dyfed-Powys. Bwriedir yr e-bost ar gyfer y person neu'r sefydliad a enwir uchod. Os derbyniwyd yr e-bost hwn trwy gangymeriad, dylid hysbysu'r anfonydd a dileu'r e-bost oddi ar eich system os gwelwch yn dda. Os na'i fwriadwyd ar eich cyfer chi ac nid chi yw'r cyflogwr na'r asiant sy'n gyfrifol am roi'r e-bost i'r derbynnydd bwriadedig, fe'ch hysbysir gan hyn na chaniateir i chi ddefnyddio, adolygu, lledaenu, dosbarthu na chopio'r e-bost ar unrhyw gyfrif. Archwiliwyd yr e-bost hwn ac unrhyw ffeiliau a drosglwyddir gydag ef am firws. Serch hynny, dylai'r derbynnydd hefyd archwilio'r e-bost a'r ffeiliau sydd ynghlwm am firws oherwydd nid yw Heddlu Dyfed Powys yn derbyn cyfrifoldeb am unrhyw ddifrod a achosir gan unrhyw firws a drosglwyddir trwy gyfrwng yr e-bost hwn.

**Dyfed Powys Police ? the lowest levels of recorded crime and highest total detection rate across the whole of England and Wales.**

**Heddlu Dyfed Powys ? y lefelau isaf o droseddau a recordiwyd a'r gyfradd ddatrys uchelaf ar draws Cymru a Lloegr gyfan.**

**WITNESS STATEMENT**

CJ ACT 1967, s.9; MC ACT 1980, ss.5A(3) (a) and 5B; Criminal Procedure Rules 2005, Rule 27.1

URN

Statement of: Michael Price

Age if under 18: Over 21 (if over 18 insert 'over 18') Occupation: Licensing Officer

In which language would you prefer to give your evidence: \_\_\_\_\_

In which language would you prefer to give your oath: \_\_\_\_\_

Is the victim or witness considered vulnerable or intimidated: Yes / No

Does the victim or witness require special measures in court: \_\_\_\_\_ \* If yes, submit MG2

This statement (consisting of 3 page(s) each signed by me) is true to the best of my knowledge and belief and I make it knowing that, if it is tendered in evidence, I shall be liable to prosecution if I have wilfully stated in it, anything which I know to be false, or do not believe to be true.

Signature: M. Price

Date: 12/04/16

Tick if witness evidence is visually recorded  (supply witness details on rear)

I am a Support Staff member of the Dyfed Powys Police and am employed as a Licensing Officer for the Carmarthenshire Division of the Dyfed Powys Police. I have been a Licensing Officer both as a uniformed Police Officer and a support staff member for over 18 years.

On the 3<sup>rd</sup>. March 2016 I was served with an application to vary a Premises Licence in respect of the Drovers Arms Hotel, 106 Lammas Street Carmarthen. The application was made by Felinfoel Brewery Company Limited to extend the hours in respect of the supply of alcohol on Friday and Saturday nights from 08.00 to 02.00 to include Bank Holidays and Christmas Eve. Also to extend the hours in respect of late night refreshment from 23.00 to 01.00 Sunday to Thursday and until 02.00 on Friday and Saturday nights and again to include Bank Holidays and Christmas Eve.

I discussed the application with Inspector Alun Samuel my line manager within the Neighbourhood Development department and was instructed to make an objection to the application.

The Police objection is based on the following.

Lammas Street Carmarthen was identified as a 'Hot Spot' for alcohol related Crime and Disorder and Anti-Social behaviour in 2007; this was as a result of a review of the Carmarthenshire County Council Licensing Policy and has remained as a 'Hot Spot' since that time.

Within Lammas Street there are 8 premises that have the benefit of a premises Licence – 6 public houses, 1 hotel and 1 night club. There are 3 premises that have the benefit of a Premises Licence for Off sales only and 3 that have the benefit of a Late Night Refreshment Licence; one does not currently trade after 11pm. The two others are open until 03.30am on Saturday and Sunday mornings for the provision of hot food. Also within the street there are official and unofficial taxi ranks that operate until there are no more customers left.

The street is a one way street with a mixture of both business and residential properties and

Signature: M. Price

Signature witnessed by: \_\_\_\_\_

DS

Continuation of Statement of:

at weekends is busy with both vehicle and pedestrian traffic until 5am. and often later especially on Bank Holiday weekends. This is as a result of the late night economy within Carmarthen town changing in 2013 when a premises in Lammas Street was granted hours until 4am on weekends for the supply of alcohol, with a further 30 minutes for 'drinking up'. This was in addition to the existing premises in the street that had a 4am. Premises Licence and had operated as a nightclub for a number of years. As a result of the second premises operating until 4am. at weekends for the supply of alcohol only, the number of persons within the street have increased, the majority have left other premises within the town centre that have closed and do not wish to pay to enter the nightclub but seek to carry on drinking until late.

In September 2015 I prepared a response to Carmarthenshire County Council in respect of a consultation document in relation to its review of their Licensing Policy. Data was provided by an analyst within the Information and Intelligence Directorate of the Dyfed Powys Police, her brief was to provide a profile for all alcohol related crime, disorder and anti-social behaviour incidents in Lammas Street from 01.05.2013 to 31.07.2015.

The report highlighted that there was a definitive correlation between crime and disorder and the evening and late night economy within Lammas Street on Saturday and Sunday. The key findings were that the largest proportion of incidents reported in respect of alcohol related crime, disorder and anti-social behaviour were between the hours of 00.00 and 03.00. The data clearly showed that levels of alcohol related crime, disorder and anti-social behaviour incidents increase during the evening hours right through until 06.00 hours in the morning where levels then start to fall.

Since February 2015 when there was a change of Designated Premises Supervisor at the Drovers Arm Hotel the character of the premises have changed with a younger crowd now as regular customers especially at weekends.

There are no recorded Crime and Disorder incidents at the premises apart from a call in December 2015 re loud music being played after 11pm. and August 2015 Police were

Signature: \_\_\_\_\_ Signature witnessed by: \_\_\_\_\_

Db

Continuation of Statement of:

called to the premises in relation to a resident causing problems. The male who had been drinking at the bar was drunk and causing a nuisance as he was a resident he was escorted to his room to sleep it off. The officers attending noticed that prior to removing the male from the bar area that the bar maid handed back to him his bank card that had been kept behind the bar near the till, the officer took this to be for the male to continue to pay for drinks even though he was intoxicated.

The police are therefore concerned that by granting the application to vary the existing hours at the Drovers Arms Hotel will add to the already existing problems within Lammas Street in relation to alcohol related Crime and Disorder and Anti-Social behaviour.

Additional supporting evidence is currently being prepared and will be available as soon as possible.

Signature: \_\_\_\_\_ Signature witnessed by: \_\_\_\_\_

## WITNESS STATEMENT

Criminal Procedure Rules, r 27.2; Criminal Justice Act 1967, s.9; Magistrates' Courts Act 1980, s.5B

URN 

--	--	--	--

Statement of: Thomas SharvilleAge if under 18: Over 18 (if over 18 insert 'over 18') Occupation: Police SergeantIn which language would you prefer to give your evidence: EnglishIn which language would you prefer to give your oath/affirmation: English

This statement (consisting of 1 page(s) each signed by me) is true to the best of my knowledge and belief and I make it knowing that, if it is tendered in evidence, I shall be liable to prosecution if I have wilfully stated in it, anything which I know to be false, or do not believe to be true.

Signature: \_\_\_\_\_ Date: 13/04/2015Tick if witness evidence is visually recorded  (supply witness details on rear)

On Monday the 6<sup>th</sup> of April 2015 I was on duty as unformed police sergeant covering Carmarthen Town and surrounding rural areas. I was supervising six constables and two special constables.

At 0100am I took up a patrol in Lammas Street due to the volume of people out drinking in the town. I liaised with door staff at The Golden Lion and Savannahs to monitor the numbers attending. As I recall at around 0200am there were 300+ in Savannahs and there was a large queue outside.

As more people were now arriving in Lammas Street I deployed five constables to join me. I established that The Golden Lion and Savannahs were open until 0400am and Chick King and Lammas Pizza were serving until 0500am.

As other licenced venues in Carmarthen closed Lammas Street became increasingly busy throughout the night. As time went on my officers and I had to deal with a number of incidents of minor disorder and anti-social behaviour. We were able to prevent any serious offences by early intervention and directing trouble makers to leave the area.

Due to the number of people out that night I kept all six of us out on foot in Lammas Street, I kept my two remaining officers on mobile patrol around the town centre.

At 0400am Savannahs and The Golden Lion closed, Savannahs staff informed me that around 220 people were still in the club at closing time.

As both pubs emptied a large number of these people piled into the two fast food venues opposite. Due to the size of these fast food outlets and the volume of drunken people they were a natural flash point for confrontation. Both fast food outlets had security staff that were very helpful however I was required to enter Chick King on two occasions to prevent trouble flaring. I witnessed two people coming out of the fast food venues and vomiting in the street, one other male vomited onto his freshly purchased pizza.

Both fast food outlets in Lammas Street understandably act as a beacon to drunken people after a night out. This in turn means that people do not disperse after the pubs have closed and disorder and anti-social behaviour takes place in the street.

As a result of Chick King and Lammas Pizza being open until 0500am six police officers were required to remain in Lammas Street until 05.15am when I felt the crowds had dispersed sufficiently and further disorder was unlikely.

It is my view that the 0500am licence granted to the fast food outlets is excessive and results in increased anti-social behaviour. This in turn places a strain on police resources and prevents other areas of the town and county getting policed.

Signature: \_\_\_\_\_ Signature witnessed by: \_\_\_\_\_

EI

**From:** Cllr. Alan D T Speake

**Sent:** 07 March 2016 13:05

**To:** Andrew Rees

**Subject:** FW: Drovers Arms Hotel: Hysbysiad o Gais am Drwydded / Notification of Application for a Licence

Hello Andrew,

Has the TC responded to this application please yet?

Personally, I do not see a major problem nor of any anti social behaviour as the Hotel is well away from the residential area which is approximately 30m west of the Hotel.

What I am aware of is that local pubs and Hotels in this area of Town are really struggling to survive and jobs will be lost and will cause a negative impact on employment that flies in the face of CCC planning policies re: employment etc; with the loss of a number of local jobs etc; - and also possibly cause a severe impact too on a well respected three star Hotel when we are short of decent hotel accommodation.

Moreover, youngsters find it very much cheaper and therefore consume a higher volume of alcohol by driving to e.g. Tesco and Morrisons etc; which causes far more issues during the "Night time Economy".

On a major issue. I do not agree with what seems to be the stringent and inflexible stance by the Town Council who seem to be attempting to label Lammas Street a "Hot Spot" similar to the Station Road in Llanelli - which will appear to many to be lacking in any real and genuine evidence of any situation similar to years of ongoing anti social behaviour that has taken place on a regular basis in Llanelli's Station Road for many years due to the very high number of outlets selling alcohol etc;!

The number of public houses and Hotels that sell alcohol in Lammas Street are the four registered three star Hotels – ie Drovers Arms Hotel, The Falcon Hotel, Golden Lion and the New Inn Hotel -and of course a Licensed shop at the lower end that sells cheap alcohol drink opposite the Carmarthen Town Business Club.

I have never witnessed any serious issues with the Drover's Arms – either anti social behaviour or otherwise - indeed never, as it well run and well organised and also well managed and to keep these places viable for local people to socialise is very important also for the Town – businesses that provides many jobs.

I don't view a problem either with the hours requested by the owner of the Drovers Arms Hotel as a few of the Lammas Street pubs etc; are being impacted by the long hours, it seems, of heavy drinking – due to much cheaper alcohol - in "Wetherspoons" on the other side of the Town in the middle of King Street where people drink from 11am!

Kind Regards,

Cllr Alan Speake (Alan)



**From:** Cllr. Alan D T Speake  
**Sent:** 13 April 2016 15:11  
**To:** SCH Licensing  
**Cc:** Democratic Services Unit  
**Subject:** DROVERS HOTEL, LAMMAS STREET, CARMARTHEN.REQUEST APPLICATION TO SELL ALCOHOL UNTIL 2AM. SUPPORT!

**SUBMISSION TO THE LICENCING COMMITTEE of  
CARMARTHENSHIRE COUNTY COUNCIL by:  
COUNCILLOR ALAN SPEAKE.  
IN SUPPORT OF THE APPLICATION by:  
"THE DROVERS ARMS HOTEL".**

Dear SCH, Licensing Committee,

I am aware as a Town and County Councillor after reading the website etc; that the owner, or Landlord, of the "Drovers Hotel", Lammas Street, Carmarthen, has applied for a licence to sell alcohol until 2am at weekends etc;.

As a local Councillor I am also very well aware that other establishments already have a licence until much later into the morning – indeed one of them until 05.30am.

As someone who walk around our Town quite often - and converse with many local residents and people - I am also very well aware that the Drovers Arms Hotel is one of the quietest public houses in the whole of the Town – not merely compared to other licensed establishments located in Lammas Street.

Moreover, I have been informed that there have been zero "recorded" incidents or confrontations or of record of ANY anti social behaviour, nor any instances of assaults, confrontations, violence etc; committed by any individuals – whether inside or outside of the Drovers Hotel premises –when compared to other Public houses in this street.

The "objection" by the Police - although I hate to have to say this – I feel isn't based on any evidence of incidents etc; that I have referred to above.

Obviously, as an elected local representative, it IS my duty to be always evenly balanced and impartial in my personal assessments of any issue that the County Council are involved in – indeed since 2004 when I first was elected as a County Councillor –and previously in 2002 as a town Councillor.

E3

During my time as Councillor I have also held the positions of Carmarthen Town Sheriff in 2005-2006 and also 2008- 2009 also Mayor of our Town in 2010 – 2011.

Therefore, I did not come lightly to state what I have written what it seems both the Police and Town Council have stated. Indeed, if I came to a conclusion and believed that the application for a licence until 2am at the Drovers Hotel would be detrimental to the Town and local area then I would have objected immediately.

However, there seems to be absolutely zero evidence or ANY record of recorded affrays, violence, or confrontations, whether either inside, or outside, of the Drovers Arms Hotel.

I therefore came to a conclusion after lengthy deliberations and time that possibly the Police may have received inaccurate and therefore incorrect information from other landlords and public house owners etc;?  
IF not, then where is this written recorded evidence etc of any incidents?

There are two licensed premises located approximately 30m and 50m to the west of this Hotel in question and one approximately 150m to the east along Lammas Street and they are open much later than the applicants the Drover's Arms Hotel.

Indeed, I believe it would be possibly advantageous that possibly SCH Licensing and possibly the Licensing Committee attend a site visit to view for themselves - and at first hand – possibly on a late Friday and Saturday evening to be able to view a possibly more accurate picture of the situation.

I fully support the Application by the Drovers Arms Hotel based on the evidence I have obtained.

Yours faithfully

Cllr Alan Speake,  
8, Penycae,  
Johnstown,  
Carmarthen,  
SA31 3SD

E4

Tel: 01267 234377 (ans)

Ps) SCH.

I will require a copy please asap of my personal submission(s) and of the evidence that you have received my submission and my support for the application?

Mae'r dudalen hon yn wag yn fwriadol